

FOR LEASE ±4,132 SF

231 E. Palais Street, Anaheim, CA



HIGH-IMAGE CREATIVE OFFICE/SHOWROOM SPACE

Property Features

- 4,132 Sq. Ft. Total
- Two (2) Large Fenced Yard Areas
- 3:1 Parking Ratio
- Desirable Platinum Triangle Location
- Oversized 22,499 Sq. Ft. Parcel
- General Commercial Zoned (C-G)
- Multiple Uses Accepted
- Immediate Access to the 5, 57, and 22 Freeways



MIKE HEFNER, SIOR
Executive Vice President
714.935.2331
Lic. #00857352
mhefner@voitco.com

MORGAN HILL
Vice President
714.935.2322
Lic. #01877356
mhill@voitco.com

Voit
REAL ESTATE SERVICES

HV HEFNER
VERNICK
TEAM

FOR LEASE ±4,132 SF

231 E. Palais Street, Anaheim, CA

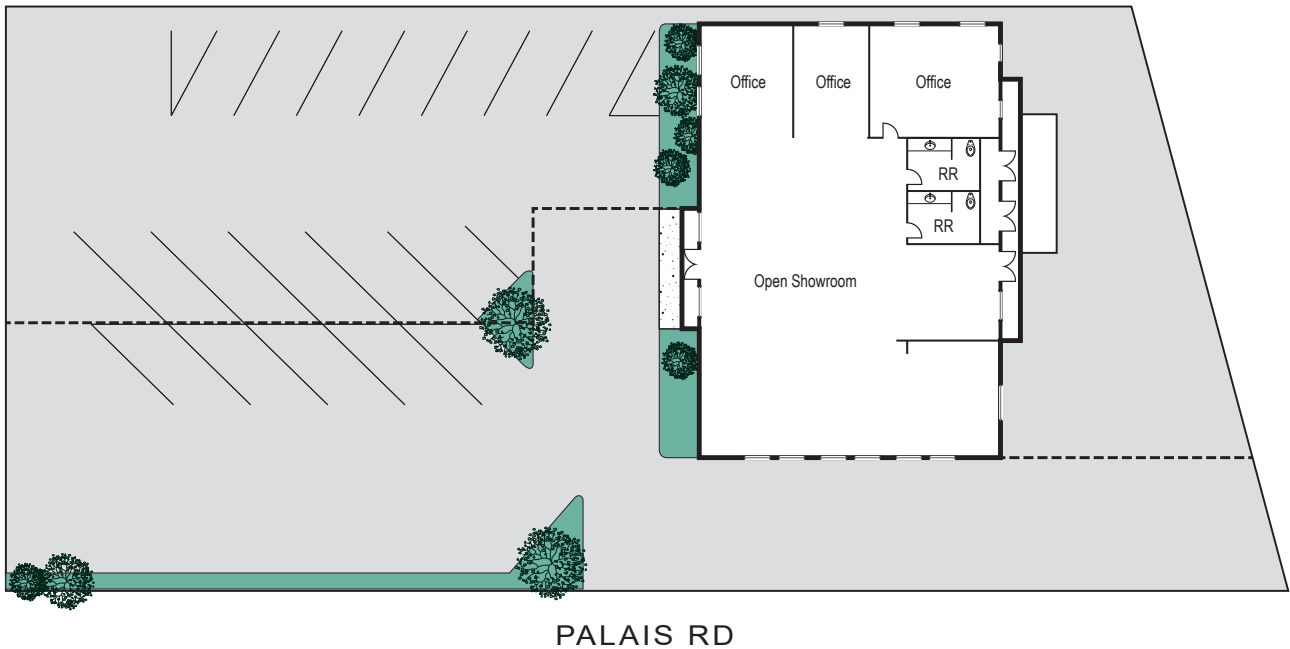

MIKE HEFNER, SIOR
Executive Vice President
714.935.2331
Lic. #00857352
mhefner@voitco.com

MORGAN HILL
Vice President
714.935.2322
Lic. #01877356
mhill@voitco.com

Voit
REAL ESTATE SERVICES

HV HEFNER
VERNICK
TEAM

2400 E. Katella Ave., Suite 750, Anaheim, CA 92806 • 714.978.7880 • 714.978.9431 Fax

Licensed as Real Estate Broker(s) and Salesperson by the CA Bar of Real Estate. The information contained herein has been obtained from sources we deem reliable. While we have no reason to doubt its accuracy, we do not guarantee it. ©2019 Voit Real Estate Services, Inc. All Rights Reserved. License #01991785.

www.VoitCo.com
www.HefnerVernickTeam.com