

FOR LEASE 48,772 Sq.Ft.

2091 Raymer Avenue, Fullerton



Property Features

- State of the Art Distribution Building
- Approx. 2,653 Sq. Ft. of Office Area
- Part of a Larger 70,414 Sq. Ft. Building
- 10 Dock High Loading Doors
- One (1) 12'X12' Ground Level Door
- One (1) 22'X20' Ground Level Door
- 30' Warehouse Clearance
- 600 AMPS of Power
- ESFR Fire Sprinkler System
- Convenient Access to 5, 91 and 57 Freeways



Voit

REAL ESTATE SERVICES

Michael Hefner, SIOR
Executive Vice President
714.935.2331
mhefner@voitco.com
Lic. #00857352

Jack Faris, SIOR
Senior Vice President
714.935.2318
jfaris@voitco.com
Lic #00912766

FOR LEASE 48,772 Sq.Ft.

2091 Raymer Avenue, Fullerton

SITE PLAN

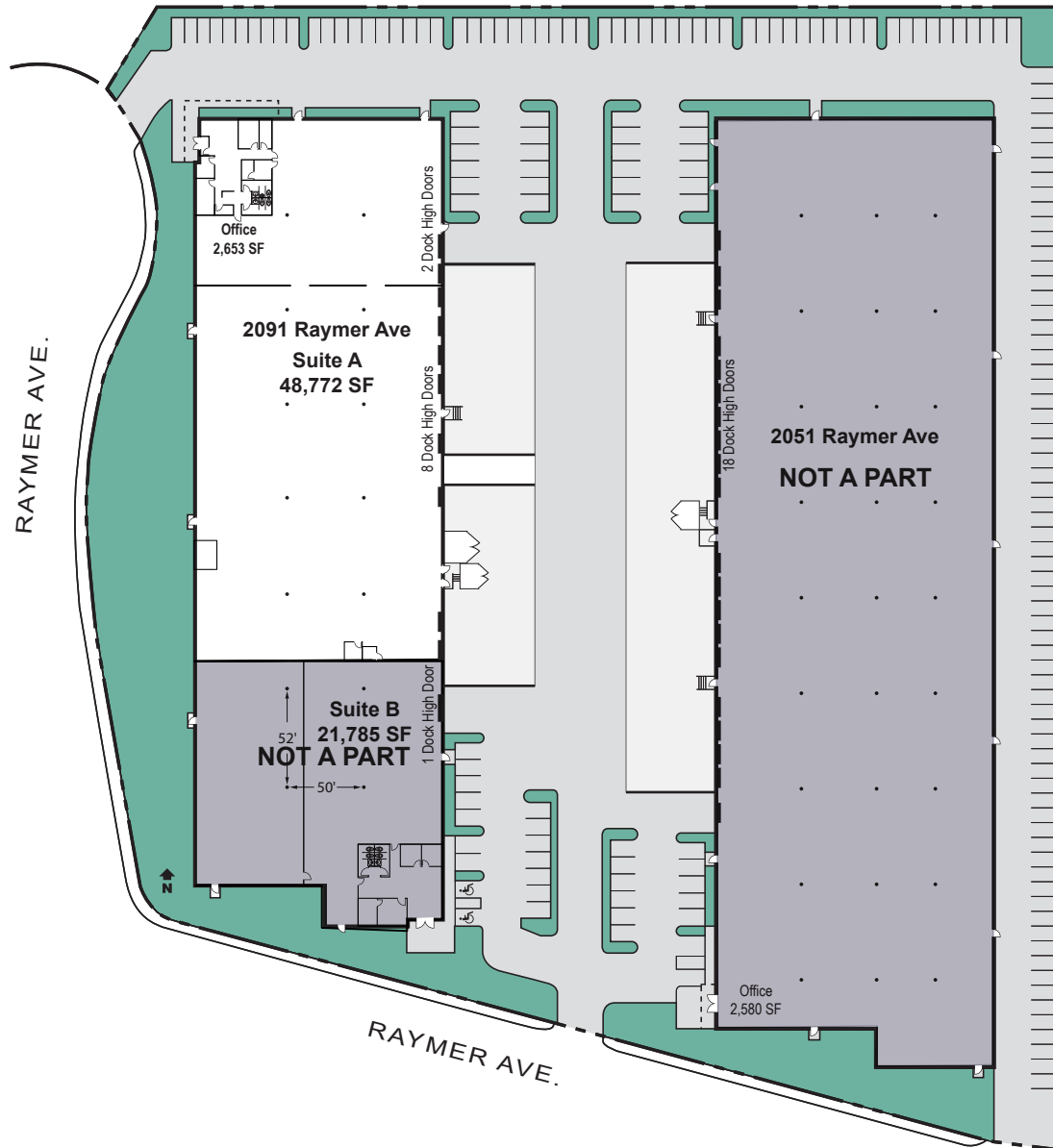

Michael Hefner, SIOR
Executive Vice President
714.935.2331
mhefner@voitco.com
Lic. #00857352

Jack Faris, SIOR
Senior Vice President
714.935.2318
jfaris@voitco.com
Lic #00912766

Voit

REAL ESTATE SERVICES