

# FOR SUBLEASE (LONGER DIRECT LEASE AVAILABLE)

±48,772 Sq.Ft.

2091 RAYMER AVENUE, FULLERTON



## Property Features

- ±48,772 SF State of the Art Distribution Space
- ±2,653 Sq. Ft. of Office Area
- 10 Dock High Loading Doors
- One (1) 12'X12' Ground Level Door
- One (1) 22'X20' Ground Level Door
- 30' Warehouse Clearance
- 800 AMPS (277/288 Volt) Power (Verify)
- ESFR Fire Sprinkler System
- 50 x 52 Column Spacing
- Convenient Access to 5, 91 and 57 Freeways
- Sublease Expiration Date: July 31, 2022- Longer Direct Lease Term Possible

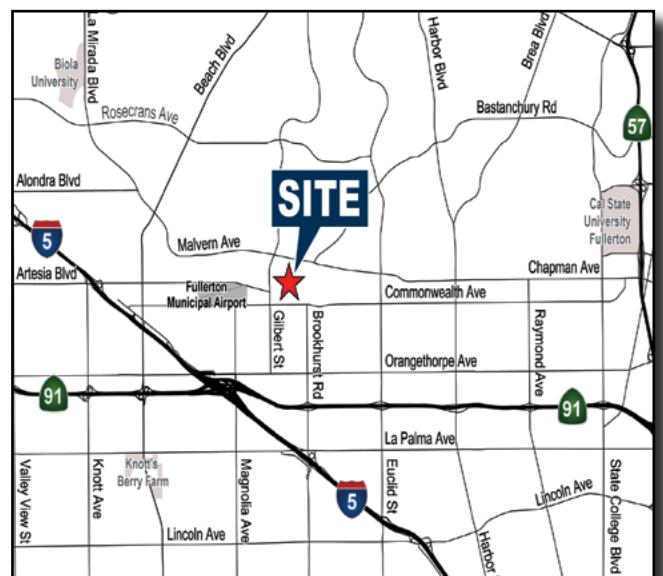

[> VIRTUAL TOUR LINK](#)

**MIKE HEFNER, SIOR**  
Executive Vice President  
714.935.2331  
Lic. #00857352  
mhefner@voitco.com

**MIKE VERNICK, CCIM, SIOR**  
Senior Vice President  
714.935.2354  
Lic. #01420885  
mvernick@voitco.com

**Voit**  
REAL ESTATE SERVICES

**HEFNER  
VERNICK  
TEAM**

# FOR SUBLEASE (LONGER DIRECT LEASE AVAILABLE)

±48,772 Sq.Ft.

2091 RAYMER AVENUE, FULLERTON

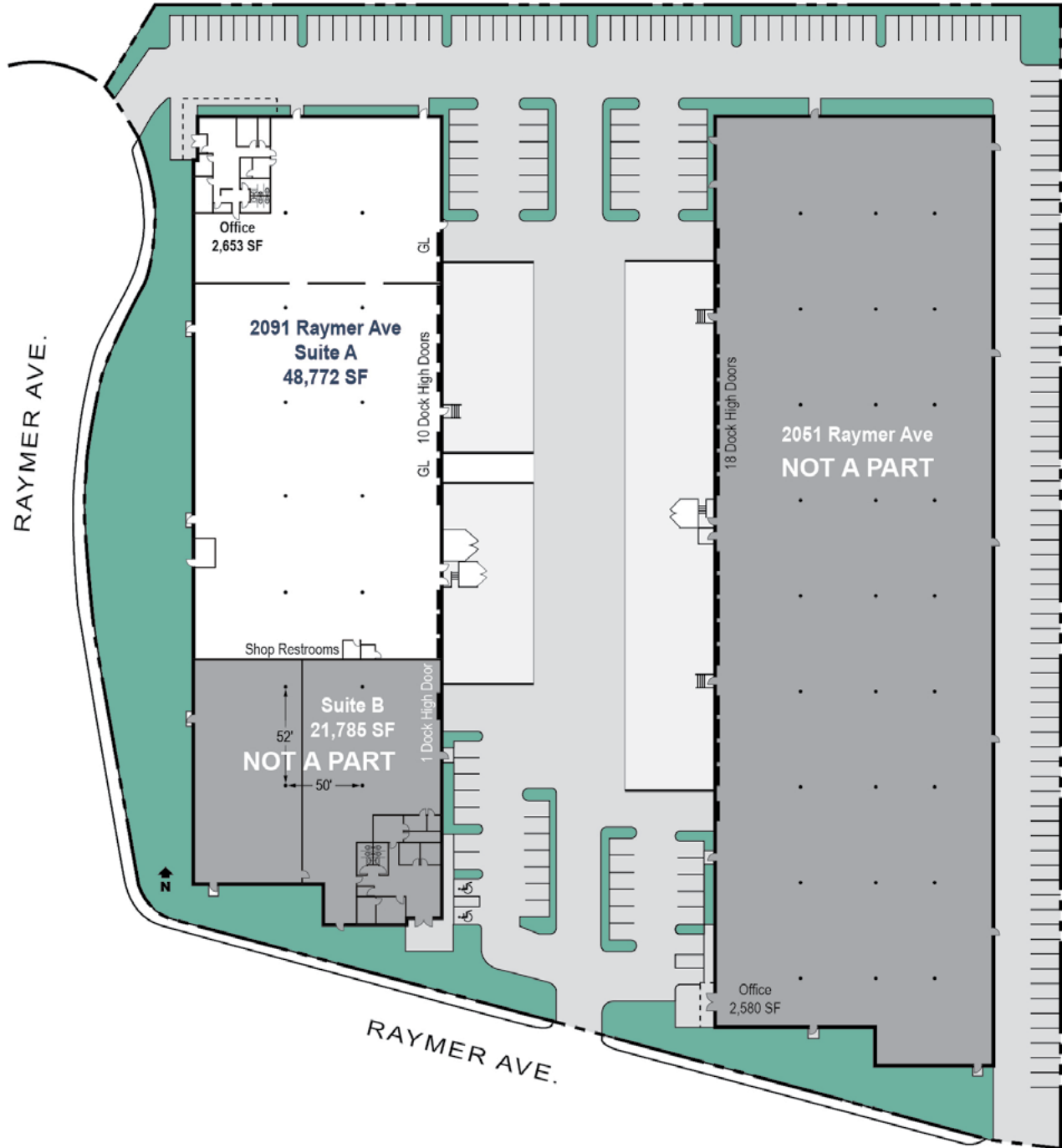

> VIRTUAL TOUR LINK

**MIKE HEFNER, SIOR**  
Executive Vice President  
714.935.2331  
Lic. #00857352  
mhefner@voitco.com

**MIKE VERNICK, CCIM, SIOR**  
Senior Vice President  
714.935.2354  
Lic. #01420885  
mvernick@voitco.com

**Voit**  
REAL ESTATE SERVICES

**HV** HEFNER  
VERNICK  
TEAM

2400 E. Katella Ave., Suite 750, Anaheim, CA 92806 • 714.978.7880 • 714.978.9431 Fax

www.VoitCo.com

Licensed as Real Estate Broker(s) and Salesperson by the CA Bur of Real Estate. The information contained herein has been obtained from sources we deem reliable. While we have no reason to doubt its accuracy, we do not guarantee it. ©2017 Voit Real Estate Services, Inc. All Rights Reserved. License #0133376.