

# FOR LEASE

## ±15,405 Square Feet

**Voit**  
REAL ESTATE SERVICES



## 331 W. Levers Place, Orange

### Property Features

- ±1,500 Sq. Ft. of Office Space
- 18' Minimum Warehouse Clearance
- Two (2) 12' x 14' Ground Level Loading Doors
- Two (2) Dock High Doors
- Fire Sprinklered (.21 GPM/1,500 Sq. Ft.)
- 400 Amps of Distributed Power
- Double Exterior Truck Well
- Drive Around Access
- 2:1000 Parking Ratio
- Excellent Access to the 57, 91 and 5 Freeways

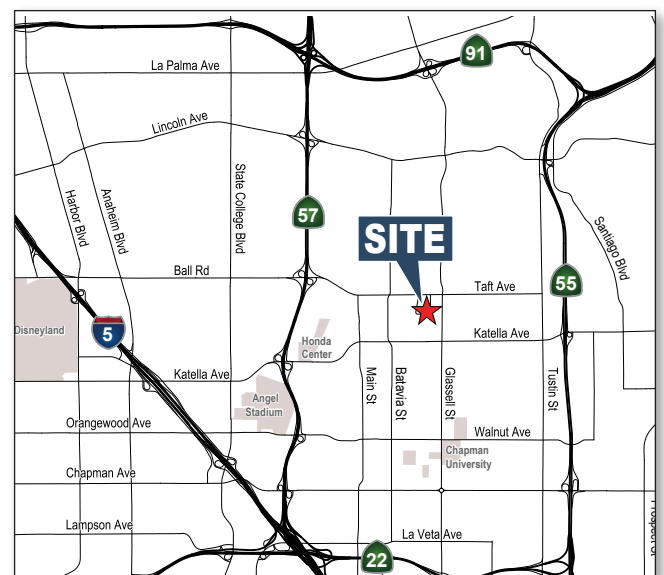

**Mike Hefner, SIOR**  
Executive Vice President  
714.935.2331  
mhefner@voitco.com  
Lic #00857352

**Brenden Hefner**  
Associate  
714.935.2326  
bhefner@voitco.com  
Lic. #02114046

# FOR LEASE

±15,405 Square Feet

331 W. Levers Place, Orange

**Voit**  
REAL ESTATE SERVICES



**HEFNER  
VERNICK  
TEAM**

Site Plan

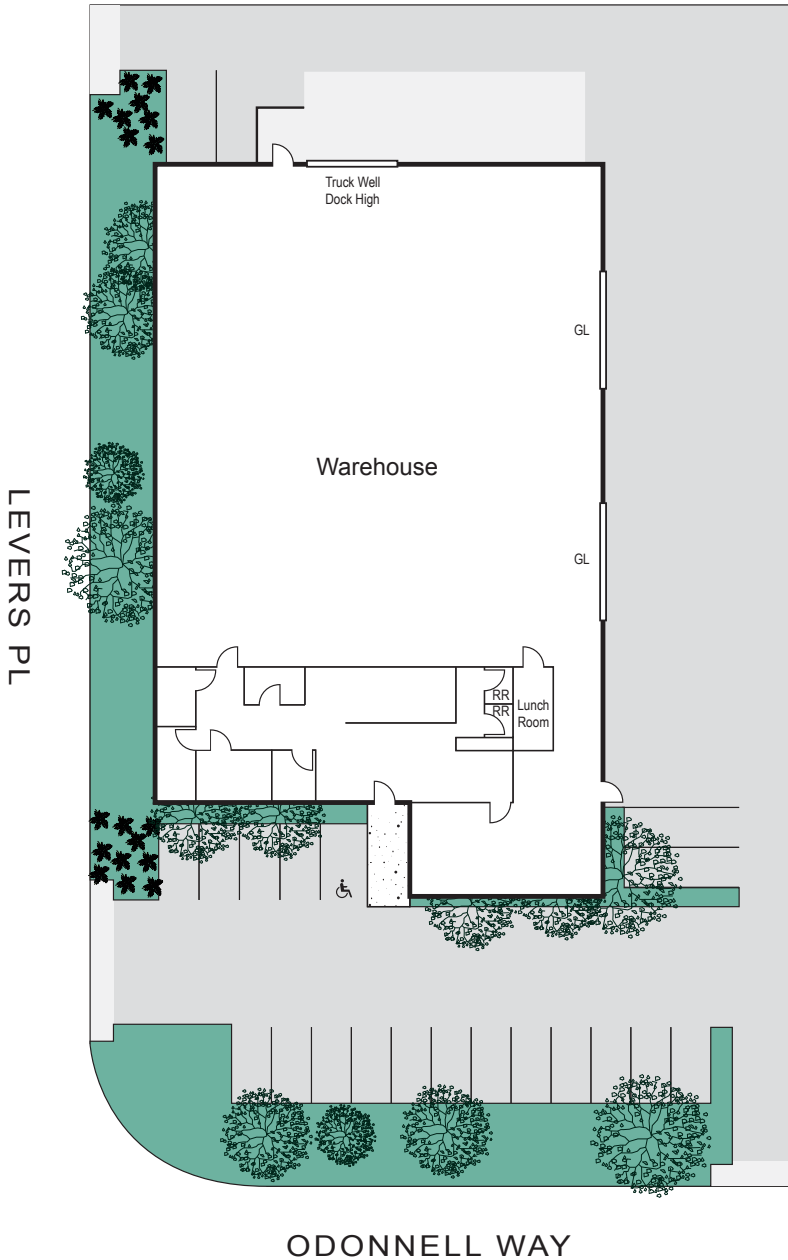

Aerial



**Mike Hefner, SIOR**  
Executive Vice President  
714.935.2331  
mhefner@voitco.com  
Lic #00857352

**Brenden Hefner**  
Associate  
714.935.2326  
bhefner@voitco.com  
Lic. #02114046